

12 November 2008

## > Returned Service League of Australia (Victorian Branch) Inc.





ATM facilities would only be available to and accessible by current financial Service, Affiliate and Social members of the RSL who hold an approved RSL membership card. This would include RSL members exercising reciprocal rights.



## RSL // Providing a Service with Integrity

RSL SUBMISSION CONCERNING THE REMOVAL OF ATM'S FROM LICENSED GAMING VENUES IN VICTORIA

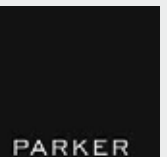

Parker Design © 2008

All ATM's would be located in a designated secure area that can only be accessed by use of a members card, such as a member's only bar, or in the alternative where that is not able to conveniently occur.

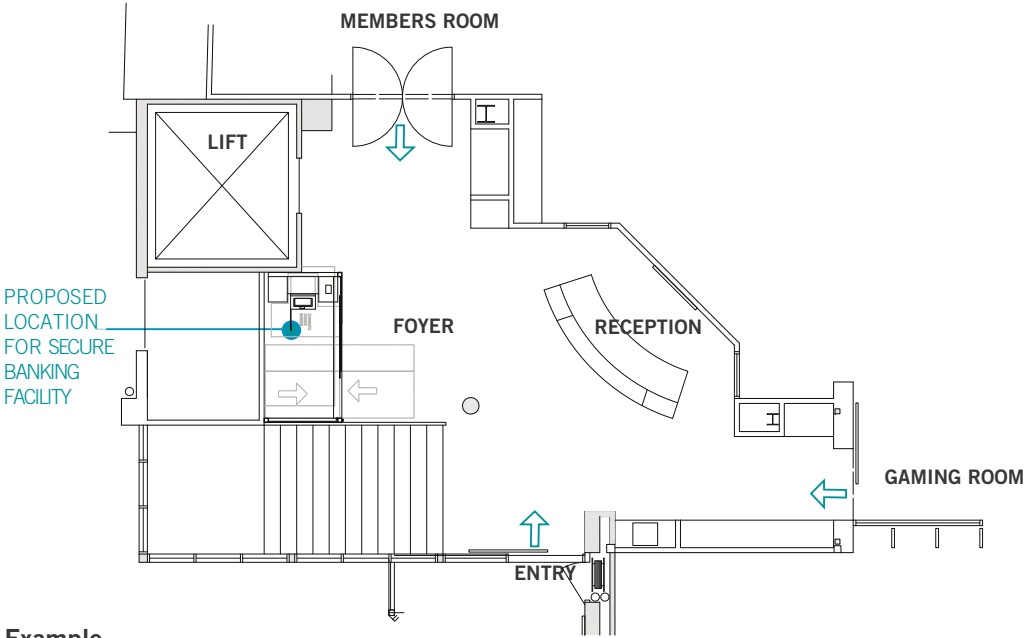

Example  
Entry Foyer Area  
Greensborough RSL Sub Branch

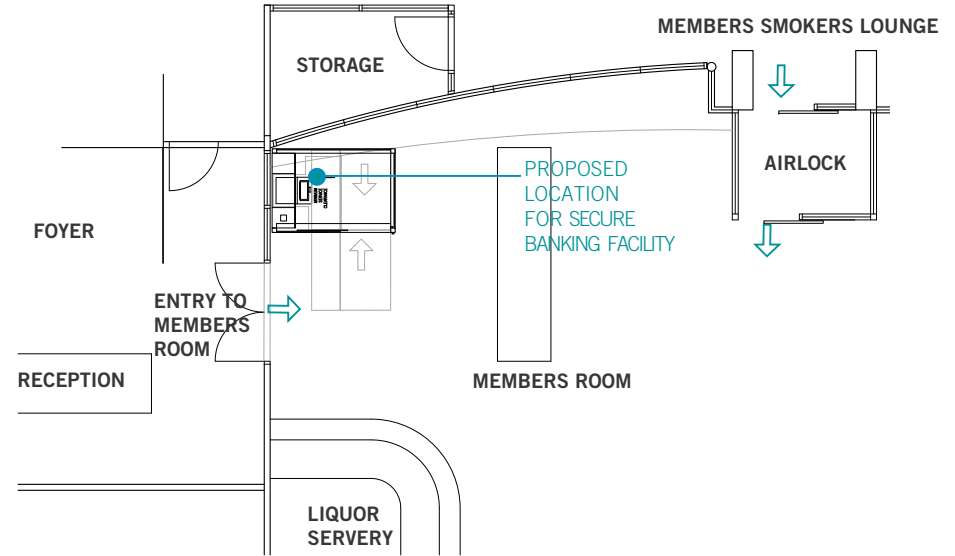

Example  
Members Room  
Watsonia RSL Sub Branch



RSL // Providing a Service with Integrity

RSL SUBMISSION CONCERNING THE REMOVAL OF ATM'S FROM LICENSED GAMING VENUES IN VICTORIA



Parker Design © 2008

- > Access to all restricted areas would be monitored by electronic swipe access panels or card readers.
- > All RSL membership cards shall enable the encryption of the card for members to either be identified as a self excluded person, or in the alternative to be excluded from the use of ATM facilities.
- > All ATM screens would be programmed to provide responsible messages.
- > All ATM's would produce a receipt that will have printed on it a suitable responsible gaming message.
- > ATM's will be programmed only to dispense \$20 notes up to a maximum of \$200.00 in any one transaction and \$400.00 in any one day.
- > The RSL membership card is common across the whole of the Victorian RSL network and any encryption on the card to restrict access will apply to all RSL Sub-Branches in Victoria.



## RSL // Providing a Service with Integrity

RSL SUBMISSION CONCERNING THE REMOVAL OF ATM'S FROM LICENSED GAMING VENUES IN VICTORIA



Parker Design © 2008



## RSL // Greensborough / Entry Foyer Concept

3D VISUAL

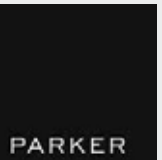

Parker Design © 2008



## RSL // Watsonia / Members Room Concept

3D VISUAL

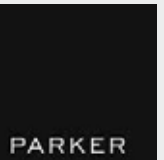

Parker Design © 2008

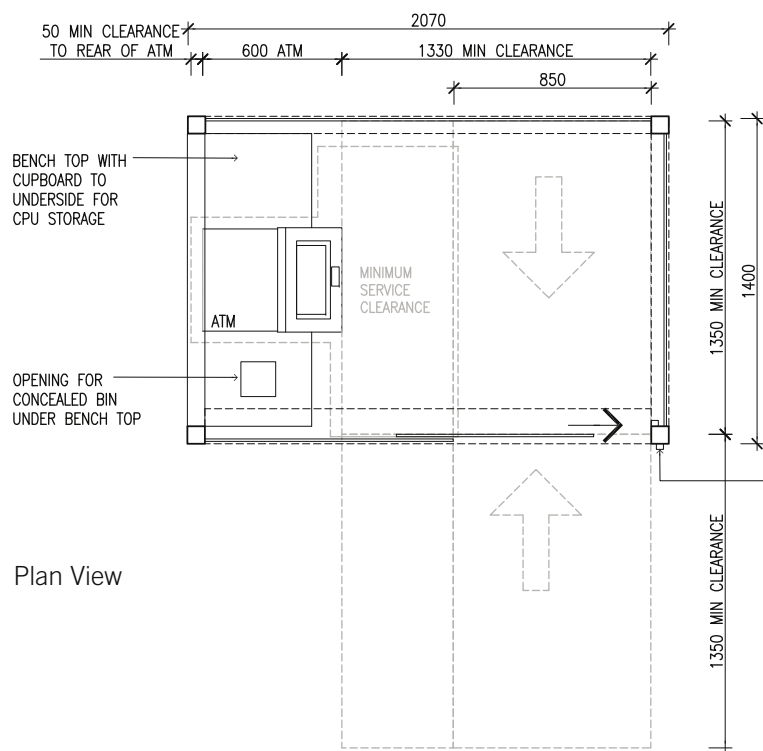

Plan View

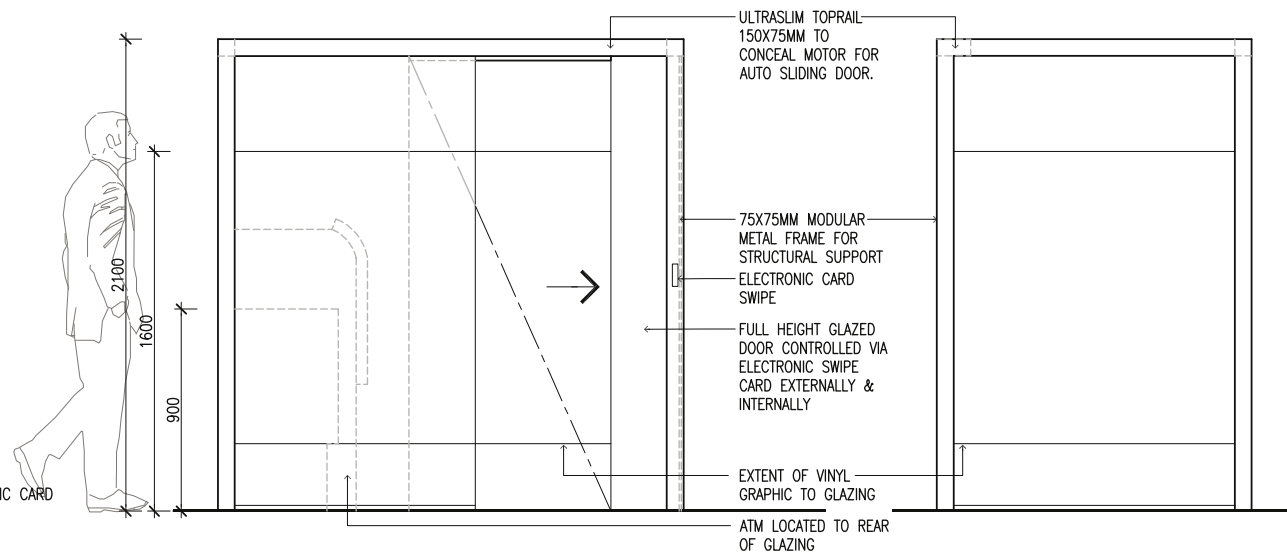

Front Elevation

Side Elevation



# RSL // Secure ATM Facility / Specifications

RSL SUBMISSION CONCERNING THE REMOVAL OF ATM'S FROM LICENSED GAMING VENUES IN VICTORIA

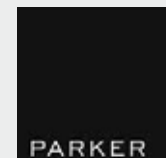

Parker Design © 2008



## Specifications

- > Minimum Size 2070mm (L) x 1400mm (W) x 2100mm (H) to be DDA Compliant
- > Modular Anodized Aluminium Frame with toughened glazing to comply with A.S 1288.
- > Ultra slim Toprail conceals motor for auto sliding door
- > Security Vision Cameras installed above ATM
- > Statutory Signage located above ATM
- > ATM surround can be used to promote responsible messages via Poster Holder
- > Electronic Card Swipe required for access by members only
- > Egress button for exit and emergency discreetly located
- > Concealed Bin & Bench located to either side of ATM for use by members
- > Vinyl Stripping applied to glazing for privacy. Colour options would be available to suit a variety of interiors (Not Shown in 3D Visual)
- > Meets all the current regulatory requirements



## RSL // Secure ATM Facility / Specifications

RSL SUBMISSION CONCERNING THE REMOVAL OF ATM'S FROM LICENSED GAMING VENUES IN VICTORIA

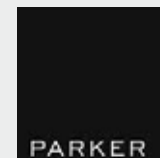

Parker Design © 2008



**Returned Service League of Australia (Victorian Branch) Inc.**

- > Providing a Service with Integrity.
- > Providing a solution to problem gambling without disadvantaging our members
- > RSL currently has the ability to initiate a prototype for a trial period

